

# GOBOSERVICE

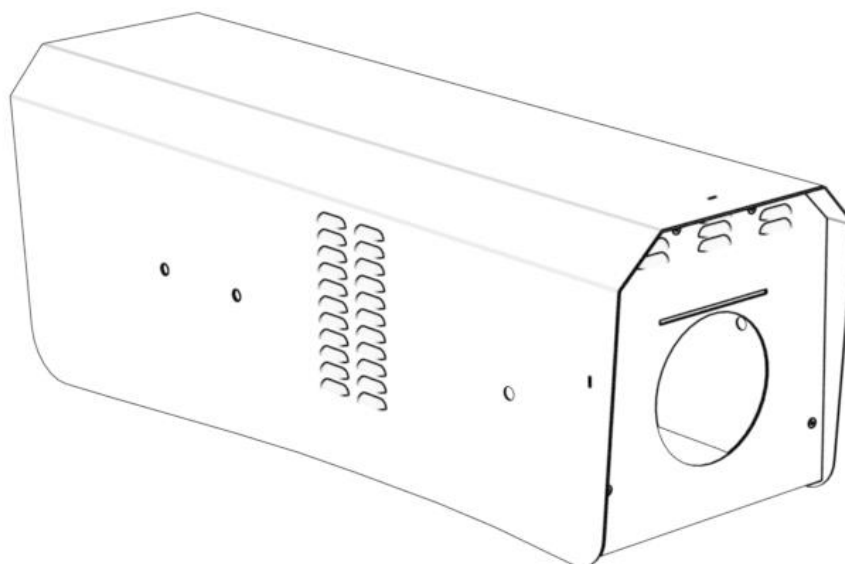

## INSTRUCTION MANUAL

# GOLUX

---

## COVER RAIN

**Goboservice by Sunland Optics SRL**  
Via Don Minzoni 14, 89125 Reggio Calabria  
+39 0965 813264  
Via Lombardia 269, 20861 Brugherio (MB)  
+39 02 23166538  
[www.goboservice.com](http://www.goboservice.com)  
[info@goboservice.com](mailto:info@goboservice.com)



## PACKAGE CONTENT

Upon receipt of the shipment check that the product is delivered in perfect condition in all its parts; Otherwise contact the manufacturer immediately.

Inside the delivery box you find:

- N° 1 COVER RAIN;
- N° 4 Screws for fastening of the component;
- N° 1 Protection Glass.

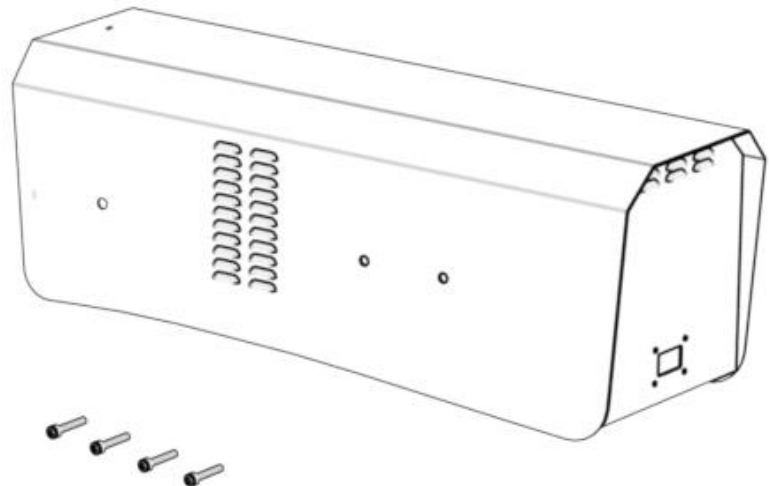

Fig. 1

Dispose of the wrapping following the current regulations.

## INSTALLATION OF THE COVER RAIN

The steps are:

1. First of all, mount the protection glass to the Rain cover with the four screws at the front of the piece.
2. Position the Rain Cover so that the side holes are aligned with those of the projector, as shown in (Fig. 2), special care to ensure that it not knick the projector's outer lens.
3. Secure the Rain Cover to the projector by tightening the four screws provided to the four corresponding holes on the projector (Fig.3)

The COVER RAIN is so mounted to the projector.

Once you installed you can still change the orientation of the projector on the bracket using the center hole of the three present (Hole A), follow the instructions from the manual (4.2. Orientation of the projector).

Fig. 2

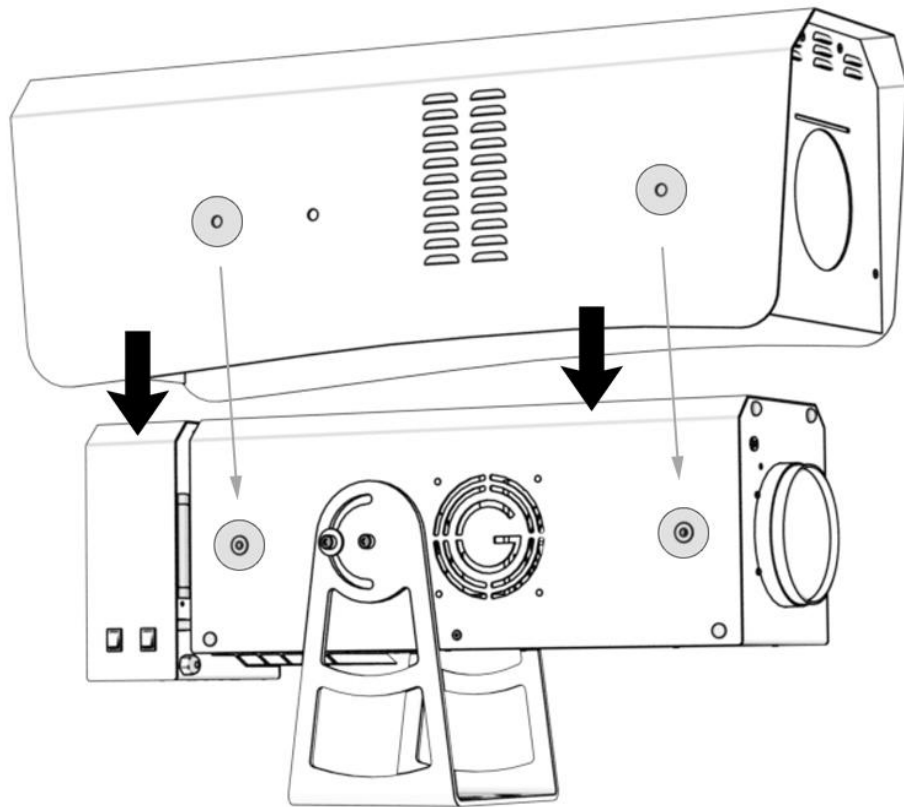

Fig. 3

